



The Collie PTA series is a 2X2 MIMO cellular, up to 2X2 MIMO Wi-Fi, and optional GPS antenna. The Collie is ideal for fixed wireless, remote video monitoring, IoT, and industrial network solutions. The antenna requires a single 1-inch mounting hole for easy install with high power antennas providing high gain connectivity in a rugged, IP67 housing.

This IP67 rated antenna can be configured to a 4x4 MIMO cellular with 2 of the cellular elements active while the remaining 2 are for failover/backup.

Patent Pending



Configurations 2:1 | 3:1 | 4:1 | 5:1

First Responders | Remote Video Monitoring | Self-Service Kiosks

Versatile

Fixed Wireless, IoT, & Industrial Networks

High Data Speeds

Ideal for Remote Video Monitoring

Durable

IP67 Rated for Power Wash Safe

- 2X2 MIMO CELLULAR
- UP TO 2X2 MIMO WI-FI
- GPS
- OMNI-DIRECTIONAL
- 698 MHz – 3.8 GHz
- 6.07 in X 2.25 in
- WI-FI 6 COMPATIBLE

Specifications

Frequencies			
4G/5G Cellular	698-960 MHz 1710-2700 MHz 3300-3800 MHz	Wi-Fi	2400-2483.5 MHz 4900-5900 MHz
4G/5G Bands			
North America	B2, B4, B5, B7, B12, B14, B17, B25, B26, B29, B30, B41, B48, B66 n2, n5, n12, n25, n26, n41, n48, n66		
EMEA	B1, B3, B7, B8, B20, B28, B42, B43 n1, n3, n8, n28, n78		
Mechanical		Environmental	
Dimension	6.07 inch X 2.25 inch	Operating Temperature	-30 °C to 85°C OR -22 °F to 180°F
Mounting	Single 1 inch	Ingress Protection	IP67
RF Cable Length	Choice of 3 or 15 foot cable		

Dimensions

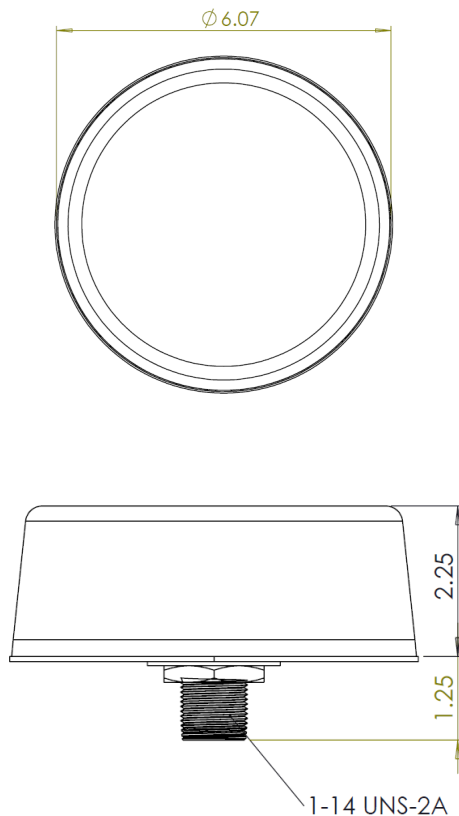

Hardware Accessories Included

PTA0316-316

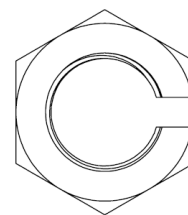

PTA0318-316

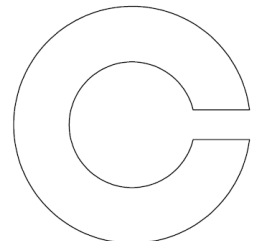

Product Images



Electrical Specifications

ID & Unit	Port	Parameters	Typ.
Radiated Efficiency (%)	CELL 1, 2	698-960 MHz	70
	CELL 1, 2	1710-2700 MHz	70
	CELL 1, 2	3300-3800 MHz	70
	Wi-Fi 1, 2	2400-2483.5 MHz	70
	Wi-Fi 1, 2	4900-5900 MHz	70
Peak Gain (dBi)	CELL 1, 2	698-960 MHz	2.4
	CELL 1, 2	1710-2700 MHz	5
	CELL 1, 2	3300-3800 MHz	5.3
	Wi-Fi 1, 2	2400-2483.5 MHz	2.4
	Wi-Fi 1, 2	4900-5900 MHz	6
Return Loss 50Ω (dB)	CELL 1, 2	698-960 MHz	7
	CELL 1, 2	1710-2700 MHz	9
	CELL 1, 2	3300-3800 MHz	11
	Wi-Fi 1, 2	2400-2483.5 MHz	10
	Wi-Fi 1, 2	4900-5900 MHz	10
Isolation (dB)	CELL 1, 2	698-960 MHz	9
	CELL 1, 2	1710-2700 MHz	15
	CELL 1, 2	3300-3800 MHz	17
	Wi-Fi 1, 2	2400-2483.5 MHz	17
	Wi-Fi 1, 2	4900-5900 MHz	27
Polarization (dBi)	CELL, Wi-Fi		Linear
Max Input Power (Watts)	CELL, Wi-Fi		5
RF Connectors	CELL		SMA(M)
	Wi-Fi		RPSMA(M)
RF Cable Type	CELL, Wi-Fi		LSR200

- Electrical specifications based on antenna with a 2 ft x 2 ft external ground plane.
- Isolation, return loss, and peak gain does not include cable loss.
- SMA connectors have a max torque of 3-5 inch lbs.
- NF connectors have a max torque of 6.2-9.7 inch lbs.
- Parsec is currently phasing out inventory with LTE on our Cellular cables (now labeled CELL). For cables labeled LTE, please refer port "CELL" in the data sheets and installation instructions.

GNSS Electrical Specifications

ID & Unit	Port	Parameters	Typ.
Antenna + Preamp Gain (dBic)	GPS	1570-1581 MHz	33
Polarization	GPS		RHCP
Filter Rejection (dB)	GPS	1625 MHz	12
GNSS Preamp Voltage (mA)	GPS		2.2 to 5
GNSS Preamp Current (mA)	GPS		5 to 15
RF Connector	GPS		SMA(M)
RF Cable Type	GPS		LSR100

Part Number Key

Part number example of a 5:1 Collie antenna, black: PRO5C2L2WG15B

Description	Abbreviation	Part Number
All PRO Series	PRO	PRO
Number of Antennas in Housing/Configuration	5:1	PRO5
Antenna Abbreviation for Collie	BC	PRO5C
Number of CELL Elements	#L	PRO5C2L
Number of Wi-Fi Elements	#W	PRO5C2L2W
Number of GPS Elements (usually only 1 GPS per antenna, therefore we simply list G and no number)	G	PRO5C2L2WG
Cable Length Measured in Feet: 01=1', 15=15'	01, 03, 06, 15, etc.	PRO5C2L2WG15
Radome Color - B for Black, W for White	B or W	PRO5C2L2WG15B
If SMA Connector, Simply Leave Blank		PRO5C2L2WG15B
Custom connectors and cable kits are available. Please contact us for more information at sales@parsec-t.com .		

Ordering

Standard Antennas

Configurations	Part Number	Description
3:1	PRO3C2LG15B	2 Cellular, GPS, 15 ft Cable, Black
5:1	PRO5C2L2WG15B	2 Cellular, 2 Wi-Fi, GPS, 15 ft Cable, Black

Non-Standard Antennas

Configurations	Part Number	Description
2:1	PRO2C2L01B	2 Cellular, 1 ft Cable, Black
	PRO2C2L03B	2 Cellular, 3 ft Cable, Black
	PRO2C2L01W	2 Cellular, 1 ft Cable, White
	PRO2C2L15B	2 Cellular, 15 ft Cable, Black
	PRO2C2L15W	2 Cellular, 15 ft Cable, White
3:1	PRO3C2LG01B	2 Cellular, GPS, 1 ft Cable, Black
	PRO3C2LG01W	2 Cellular, GPS, 1 ft Cable, White
	PRO3C2LG15W	2 Cellular, GPS, 15 ft Cable, White
4:1	PRO4C2L2W01B	2 Cellular, 2 Wi-Fi, 1 ft Cable, Black
	PRO4C2L2W03B	2 Cellular, 2 Wi-Fi, 3 ft Cable, Black
	PRO4C2L2W01W	2 Cellular, 2 Wi-Fi, 1 ft Cable, White
	PRO4C2L2W03W	2 Cellular, 2 Wi-Fi, 3 ft Cable, White
	PRO4C2L2W15B	2 Cellular, 2 Wi-Fi, 15 ft Cable, Black
	PRO4C2L2W15W	2 Cellular, 2 Wi-Fi, 15 ft Cable, White
	PRO4C4L01B	4 Cellular, 1 ft Cable, Black
	PRO4C4L01W	4 Cellular, 1 ft Cable, White
	PRO4C4L15B	4 Cellular, 15 ft Cable, Black
5:1	PRO5C2L2WG01B	2 Cellular, 2 Wi-Fi, GPS, 1 ft Cable, Black
	PRO5C2L2WG01W	2 Cellular, 2 Wi-Fi, GPS, 1 ft Cable, White
	PRO5C2L2WG15W	2 Cellular, 2 Wi-Fi, GPS, 15 ft Cable, White
	PRO5C4LG01B	4 Cellular, GPS, 1 ft Cable, Black
	PRO5C4LG01W	4 Cellular, GPS, 1 ft Cable, White
	PRO5C4LG15B	4 Cellular, GPS, 15 ft Cable, Black
	PRO5C4LG15W	4 Cellular, GPS, 15 ft Cable, White

Additional Hardware Accessories

Accessory	Part Number
Pole Mount Bracket Assembly	PTA0637
L Bracket, Antenna Mount Assembly	PTA0756
Magnetic Mount	PTA0330
Replacement Rooftop Gasket	PTA0561
Hardware Kit for 1" Shaft - Nut/Washer	PTA0760
Star Washer	PTA0251
Ground Plane with Adhesive Back, 20 in x 20 in, Can Be Cut to Size	PTA0587
Lightning Arrestor - SMA(F) to SMA(F)	PTA0476
Lightning Arrestor - N(F) to N(M)	PTA0736
SMA Wrench, Key Chain	PTA0194
Service: Cable Sleeving (Priced Per Ft)	Cable Sleeving



Parsec Antennas

972-804-4600

support@parsec-t.com