

4

3

2

1

REVISION HISTORY			
REV	DESCRIPTION	DATE	APPROVED
H	OUTLINE DIMENSIONAL DRAWING	2/12/2016	CE

(15.49)

(11.61)

NEOPRENE MEDIUM DENSITY, CLOSED CELL GASKET

WASHER M14x0.75-6H

LABEL

SHRINK TUBE, ADHESIVE, LINED

NOTES: UNLESS OTHERWISE SPECIFIED

1. A (REF) DIMENSION IS FOR INFORMATION PURPOSES ONLY AND NO TOLERANCE IS IMPLIED.

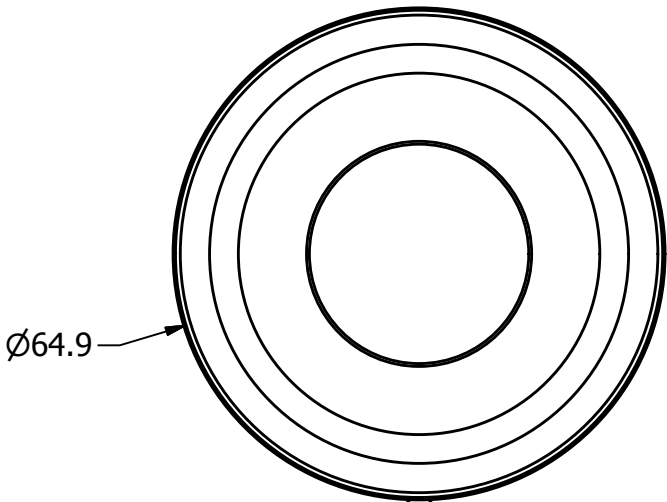

Ø64.9

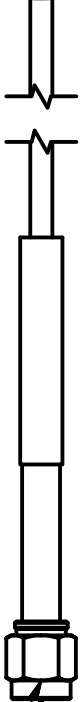

CONNECTOR, SMA PLUG,
CRIMP TYPE

SUPPLIER PRINT ACCEPTANCE:

- ☐ Accept drawing/specification:
No changes needed:
 - ☐ This part is RoHS compliant
 - ☐ This part is REACH compliant
 - ☐ Accept drawing/specification.
Notes/Mark-ups added
 - ☐ Cannot accept drawing/spec.
Notes/Mark-ups added
- Supplier Projected Outgoing Quality:

SIGMA LEVEL : _____ or PPM: _____

Signature _____ Date: _____

UNLESS OTHERWISE SPECIFIED
DIMENSIONS ARE IN MILLIMETERS

FOR TOLERANCES NOT SPECIFIED USE:
[X mm ± 3 mm] [X.X mm ± .3 mm]
[X.XX mm ± .13 mm] ANGULAR ± 1°

THIRD ANGLE PROJECTION

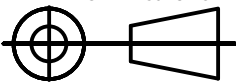

PCTEL PROPRIETARY DATA

THE INFORMATION AND/OR DRAWINGS CONTAINED IN THIS DOCUMENT IS
CONFIDENTIAL AND PROPRIETARY TO PCTEL, INC. AND MAY NOT BE USED,
REPRODUCED, IN WHOLE OR IN PART, OR MODIFIED IN ANY WAY WITHOUT
THE EXPRESS WRITTEN PERMISSION OF AN AUTHORIZED
REPRESENTATIVE OF PCTEL, INC.

DRAWN
CE 12/21/2016

CHECKED
IP 12/21/2016

MATERIAL: SEE COMP.
PRINTS

FINISH: SEE COMP.
PRINTS



PCTEL, INC.
471 BRIGHTON DRIVE
BLOOMINGDALE, IL 60108
PH. 630-372-6800
FAX. 630-372-8077

DESCRIPTION
VTA, GPS L1, 26DB, MSMA

DRAWING NO.
3226MSMA

SIZE B SCALE N/A SHEET 1 OF 1